

## LAKESWOOD SPRINGS COMMONS, PLANO, ILLINOIS

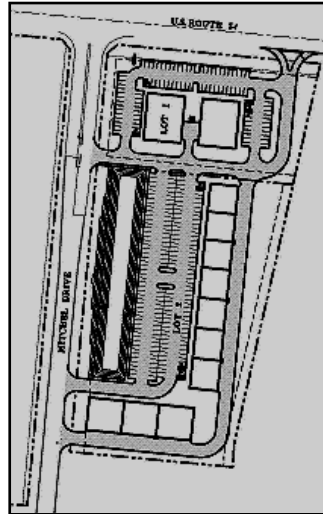

Engineering and Surveying Services were provided for the development of 58,150 square feet of gross building area within four retail buildings on an eight acre site. Site improvements included: a storm water management facility, 860 LF of sanitary sewer extension, 2,300 LF of 12-inch watermain connecting two existing City owned watermains, on-site storm sewers, access road roads and 273 vehicle parking lot, detailed site grading, and soil erosion and sedimentation control measures. Coordination with the City of Plano, Illinois Environmental Protection Agency, Illinois Department of Transportation and other agencies for the necessary permits were also included.

**Client:** Lakewood Springs 8, LC

**Services Provided:**

- Prepared Conceptual Site layout
- Prepared Preliminary and Final Site Engineering Plans and the appropriate construction documents
- Provided drainage and stormwater management calculations and design
- Provided coordination and preparation of permit applications for IHPA, IDNR, IEPA, IDOT and the City of Plano

This project reflects Firm  
and Staff experience.